



BRIEF INFORMATION

Module 70 S series

- Halogen replacement series
- Longer life and higher efficiency compared to halogen
- Low weight and high corrosion resistance thanks to plastic material

PRODUCT FEATURES

With the S series, HELLA is launching another model of the well-known Module 70 series. The high-quality yet affordable work lamps are suitable for use in a wide variety of applications outside of road traffic. They can be used for upgrading or retrofitting forklifts, trucks and trailers as well as for agricultural machinery, construction machinery, municipal vehicles and other special vehicles. Thanks to their universal and slim design, they are the perfect replacement for halogen. This means that vehicles be converted to LED technology quickly and easily.

Compared to halogen devices, the round LED work lamps have an excellent lumen/watt output and, therefore, a high efficiency. Another plus point is their long lifetime, which is mainly thanks to effective overheating protection: the efficient new cooling fin design provides better heat dissipation, while the integrated thermal management automatically dims the headlamps at temperatures between + 50 °C and + 85 °C.

The S series work lamps provide homogeneous illumination with a light colour similar to daylight. The colour temperature is 6,500 kelvin. The housing and the cover lens are made of special plastics, which keep them very lightweight and provide a high level of corrosion resistance.

The work lamps meet the highest EMC requirements and are produced in Austria in accordance with the latest technological standards.

TECHNICAL DETAILS



Technical data

Variant	1,000	1,850
Operating voltage	Multi-voltage (9 – 32 V)	
Rated voltage	12 V / 24 V	
Current consumption	1.1 A (12 V) 0.6 A (24 V)	1.6 A (12 V) 0.8 A (24 V)
Power consumption	12 W	19 W
Light output	1,000 lm	1,850 lm
Light source	LED	
Colour temperature	6,500 K*	
Material	Housing: heat-conductive plastic Cover lens: plastic	
Weight	228 g	235 g
Temperature range	- 40 °C to + 85 °C Maximum light output up to + 50 °C Reduced light output between + 50 °C and + 85 °C**	
Protection class	IP 6K7, IP 6K9K	
Type approval	UKCA, ECE-R10, RCM, ADR / GGVSEB	
EMC protection	CISPR 25	
Mounting	Upright and pendant	
Connection	DEUTSCH DT connector	
Manufactured in	Austria	



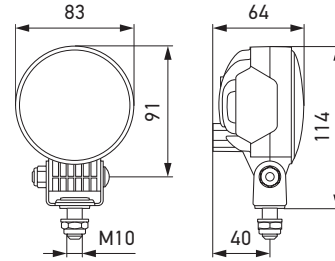

* 5,000 K variants available on request.

** From + 50 °C to + 85 °C, the work lamp dims automatically to protect itself.

Dimensional sketch



PROGRAM OVERVIEW

Product picture	Variant	Illumination	Part number
	1,000	Close-range illumination	1G0 996 776-001
		Long-range illumination	1G0 996 776-011
	1,850	Close-range illumination	1G0 996 776-201
		Long-range illumination	1G0 996 776-211

ACCESSORIES

Product image	Description	Part number
	2,000 mm cable with DEUTSCH DT connector	8KB 990 299-011

LIGHT DISTRIBUTION

Variant 1,000

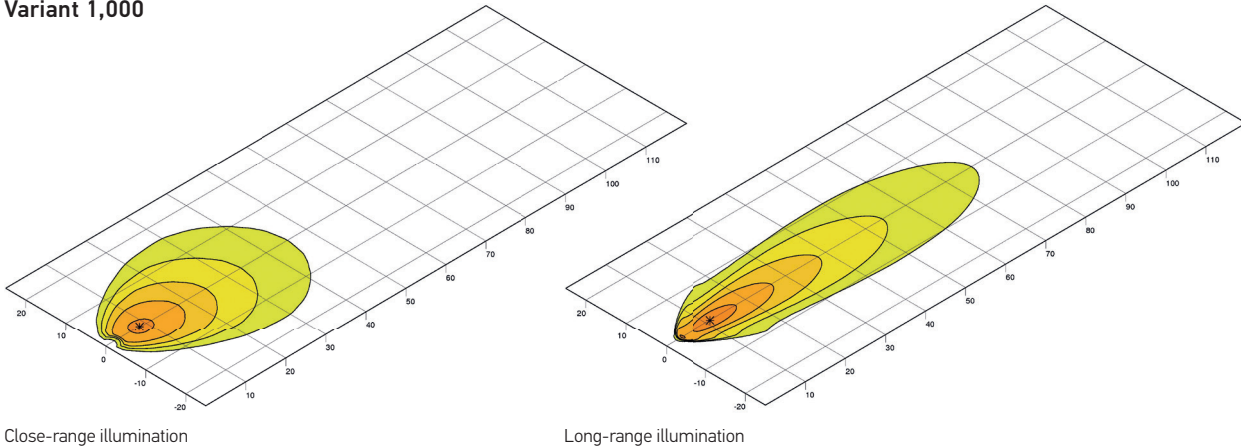

Close-range illumination

Long-range illumination

Variant 1,850

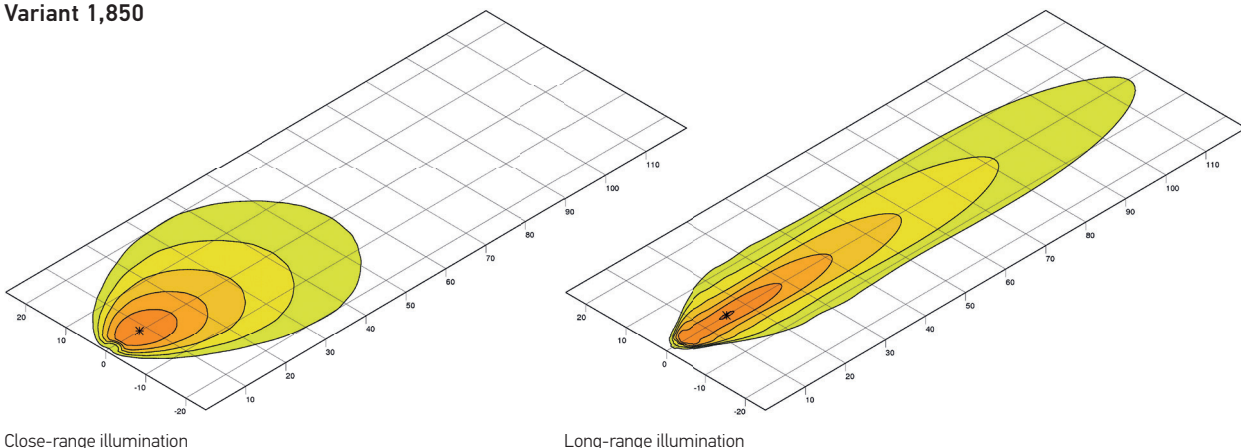

Close-range illumination

Long-range illumination

