



## BRIEF INFORMATION

### 83 mm LED position, daytime running and direction indicator lamp

- Combination lamp with 3 different functions: LED position light, daytime running light and direction indicator light
- More illumination and safety through innovative LED technology
- Maximum design and technological freedom thanks to modular system
- For the most diverse applications and maximum demands

### PRODUCT FEATURES

The 83 mm LED position, daytime running and direction indicator lamp combine a compact design with easy mounting. A central bolt including anti-twist protection ensures practical attachment. The high-power LEDs offer an excellent signal effect and guarantee a very long service life. With low energy consumption and very good light performance, they contribute to better recognition of the vehicle and thus to a reduction in accidents. The acrylic lens used has a high UV resistance and has been tested for impact resistance. HELLA daytime running and position lamps produce a passive yet radiant white signal light. This allows other road users to notice the vehicle earlier and easier. This brings extra reaction time and offers a clear safety advantage.

#### **Advantages of driving with daytime running light:**

- Daytime running light offers you a decisive safety advantage in road traffic and prevents approx. 58 % of accidents with serious injuries
- It is much easier to notice than normal low beams
- Your own visibility is significantly increased
- The vehicle is noticed earlier and can therefore provide more reaction time in those decisive seconds
- Significantly reduced fuel consumption compared with driving with low beams

# FUNCTIONS



Position lamp



Daytime running lamp



Direction indicator

# TECHNICAL DETAILS

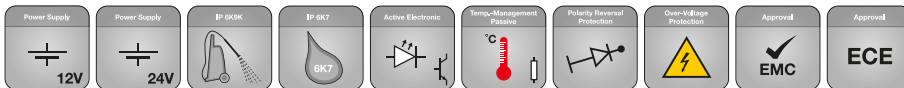

## Technical data

Operating voltage	12 – 24 V		
Energy consumption		<b>12 V</b>	<b>24 V</b>
	Direction indicator	3 W	4 W
	Daytime running lamp	4 W	4 W
	Position lamp	1 W	1 W
Functions	Direction indicator light*, position light, daytime running light		
Operating temperature	-40 °C to +60 °C		
Service life	"Fit and Forget" vehicle life		
Attachment	1 central bolt including anti-twist protection		
Cable length	Prewired with 2,500 mm long sheathed four-wire cable		
Mounting	Single screw 1 / 4 " rust-free UNC thread. Nut and washer are supplied.		
Voltage peak protection	According to ISO 7637		
Protection class	IP 6K7 and IP 6K9K		
Specification	HELLA norm 67001 Class 10		
Type approval	ECE 5854 Direction indicator ECE-Reg. no. 6 Position light ECE-Reg. no. 7 Daytime running light ECE-Reg. no. 87		
EMC approval	EAD 10R 04-2907		

## Dimensional sketch

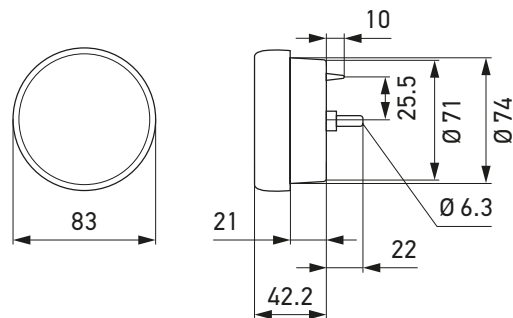

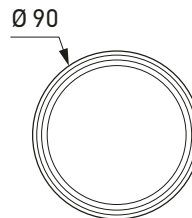

Optional accessories: Adapter ring 90 mm



\*If the direction indicator light is activated, the daytime running light switches off

## PROGRAMME OVERVIEW

Product image	Description	Operating voltage	PU	Part number
	83 mm LED position, daytime running and direction indicator lamp	12 V	1	<b>2BE 980 691-001</b>
		24 V	1	<b>2BE 980 690-001</b>
	83 mm LED position and direction indicator lamp	24 V	1	<b>2BE 980 690-301</b>
	83 mm LED daytime running lamp	12 V	1	<b>2PT 980 691-601</b>
		24 V	1	<b>2PT 980 690-601</b>

## ACCESSORIES

Product image	Description	PU	Part number
	The adapter ring is used to replace a 90 mm lamp with the 83 mm lamp. Vehicles that previously used a 90 mm HELLA lamp can now be easily converted to the 83 mm lamp.	1	<b>9GD 980 696-001</b>